

# Garage Door Transmitter

Model G6T2

## 1. INTRODUCTION

In this package, you will find a garage door transmitter with 12V alkaline battery, a mounting bracket and a visor clip.



## 2a. PROGRAM A TRANSMITTER TO THE RECEIVER GTR

You need to do the programming in order to add the transmitter to the receiver.

Refer to the Model GTR Smart Button™ user's instruction to set up the unit. Smart Button™ can learn up to 15 remote controls.

To learn additional remote controls, follow the instructions below:

1. Press the learn button on the side of the Smart Button™.
2. Once the learn button is pressed, the LED will flash quickly. You may release the learn button.
3. Press any one of the 2 buttons on the transmitter that you want to program to the receiver.
4. Once the remote control is programmed, the LED will flash slowly, in the same way as it flashes in standby mode.
5. You may now operate the garage door opener with this new remote control.
6. To program a transmitter to control another receiver, repeat process (1) to (4) with another button on the remote control.

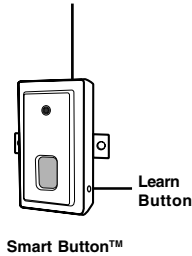

## 2b. PROGRAM A TRANSMITTER TO THE SKYLINK® GARAGE DOOR OPENER - EQ SERIES

You need to do the programming in order to add the transmitter to the Skylink® Garage Door Opener.

Refer to the Skylink® Garage Door Opener user's instruction to set up the unit.

Skylink® Garage Door Opener can learn up to 16 remote controls.

1. Press the LEARN/SET button once on the garage door opener.
2. Once the LEARN/SET button is pressed, the LEARN LED will flash. You may release the LEARN/SET button.
3. Press any one of the 2 buttons on the transmitter that you want to program to the receiver.
4. Once the transmitter is programmed, the LEARN LED will turn off.
5. You may now operate the garage door opener with this new transmitter.
6. To program a transmitter to control another garage door opener, repeat process (1) to (4) with another button on the transmitter.

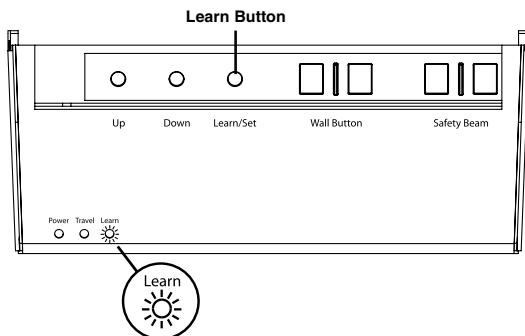

## 2c. PROGRAM A TRANSMITTER TO THE SKYLINK® GARAGE DOOR OPENER - IQ SERIES

To program the transmitter to the Skylink® IQ series Garage Door Opener, please follow the user's instruction from the Garage Door Opener.

## 3. TROUBLE SHOOTING

*Q: Door opener does not react after pressing the button on the transmitter ?*

- A:
- Ensure when the button on the transmitter is pressed, the red light on the transmitter comes on. Otherwise, check if the battery is inserted properly.
  - The appropriate button on the transmitter should be pressed.
  - Ensure the wires that are previously connected to the wall mounted door control are not loose.
  - Ensure the transmitter has been programmed to the receiver. Refer to section 2 for how to program a transmitter to the receiver.

## 4. BATTERY

12 volt alkaline battery (size 23A) (included).

It is time to change the battery when the red LED on the transmitter does not turn on when either button is pressed.

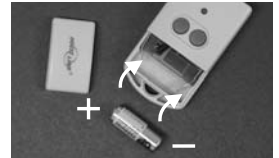

## 5. ADDITIONAL RECEIVER

There are 2 buttons on your transmitter, the other button can be used to control another Skylink® Garage Door Receiver Model GTR (sold separately).



## 6. FCC

This device complies with Part 15 of the FCC Rules. Operation is subject to the following two conditions: (1) This device may not cause harmful interference, and (2) This device must accept any interference received, including interference that may cause undesired operation.

### WARNING:

Changes or modifications to this unit not expressly approved by the party responsible for compliance could void the user's authority to operate the equipment.

### NOTE:

This equipment has been tested and found to comply with the limits for a Class B digital device, pursuant to Part 15 of the FCC Rules. These limits are designed to provide reasonable protection against harmful interference in a residential installation. This equipment generates, uses and can radiate radio frequency energy and, if not installed and used in accordance with the instructions, may cause harmful interference to radio communications.

However, there is no guarantee that interference will not occur in a particular installation. If this equipment does cause harmful interference to radio or television reception, which can be determined by turning the equipment off and on, the user is encouraged to try to correct the interference by one or more of the following measures:

- Reorient or relocate the receiving antenna.
- Increase the separation between the equipment and receiver.
- Connect the equipment into an outlet on a circuit different from that to which the receiver is connected.
- Consult the dealer or an experienced radio/TV technician for help.

## 7. WARRANTY

If, within one year from date of purchase, this product should become defective (except battery), due to faulty workmanship or materials, it will be repaired or replaced, without charge. Proof of purchase and a Return Authorization are required.

## 8. CUSTOMER SERVICE

If you would like to order Skylink's products or have difficulty getting them to work or download information and user manual, please :

1. visit our FAQ website at [www.skylinkhome.com](http://www.skylinkhome.com), or
2. email us at [support@skylinkhome.com](mailto:support@skylinkhome.com), or
3. call our toll free at 1-800-304-1187 from Monday to Friday, 9 am to 5 pm EST.  
Fax (800) 286-1320

## CUSTOMER SERVICE

17 Sheard Avenue, Brampton, Ontario, Canada L6Y 1J3  
Email: [support@skylinkhome.com](mailto:support@skylinkhome.com)  
<http://www.skylinkhome.com>  
P/N. 101Z584  
©2008 SKYLINK GROUP